



# GUINNESS™ DRAUGHT NITROSURGE™

ST JAMES'S GATE DUBLIN, IRELAND

This device must be used in accordance with the instructions.

## CONTENTS

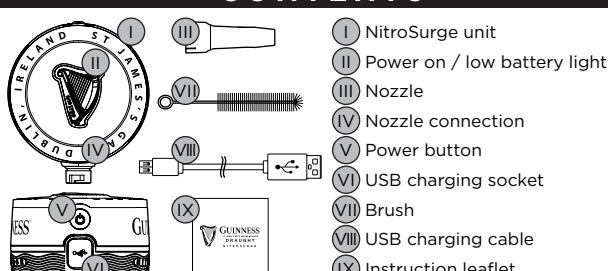

## PREPARATION FOR USE

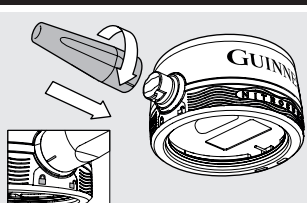

To attach the nozzle, align the indicator mark to the unlock position, then push into place as shown and twist clockwise to lock into position.



Always use a clean Guinness glass. Refrigerate cans for at least 24 hours at 4-5°C. **Only use with correct Guinness NitroSurge cans and no other cans or products.**

## POURING INSTRUCTIONS



**1.1** For best results, rinse the unit under the tap before and after use.



**1.2** Open the can slowly, then align the nozzle to the can opening and push the device firmly into place as shown.



**1.3** Push button once to activate. Harp symbol illuminates when the device is on. To cancel activation push button a second time.

### FIRST POUR

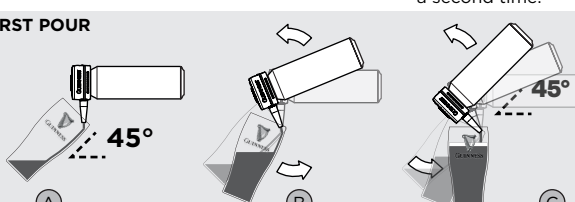

**1.4 (A)** Hold glass at 45 degrees and raise can to horizontal position to start pour. **(B)** As the beer flows, gradually tilt the can and glass together until the can is at 45 degrees and the glass is vertical. **(C)** Stop pouring when the glass is 3/4 full. Do not touch the nozzle on glass.



**1.5** Allow first pour to settle for approximately 60 seconds.



**1.6** Angle can at 45° to slowly top up the glass, forming the classic Guinness domed head. Do not push the button for the second pour, this starts automatically.

## CLEANING

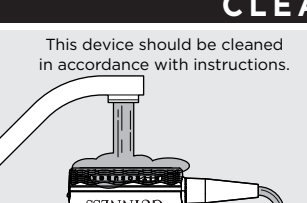

This device should be cleaned in accordance with instructions.

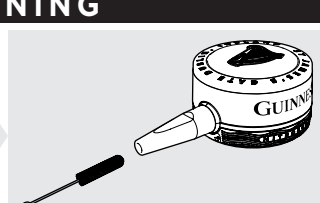

Clean before and after every use under warm running water. **Do not wet USB cable and ensure USB port is closed with rear rubber cover before washing to avoid water entering.** Do not clean the appliance in dishwasher/glass washer. Clean nozzle regularly with supplied brush.

## SAFETY INFORMATION

### Important safety information

Read this important information carefully before you use the appliance and its accessories and save it for future reference. Store in a safe place - appliance must be kept out of reach of children at all times. The accessories supplied may vary for different products.

### Danger

- Do not wet USB cable and ensure USB port is closed with rear rubber cover before washing to avoid water entering.

### Warning

- The supply unit contains a Micro-USB/USB-A charging cable. Use with standard 5V 500mA USB power source - not supplied with product.
- This appliance should only be used by persons of legal drinking age and above.
- Appliance must be kept out of reach of children at all times. Cleaning and user maintenance shall not be carried out by children.
- Always remove USB cable and unplug from power source before washing the device. Remember to close rear rubber cover before wetting.
- Always check the appliance before you use it. Do not use the appliance if it is damaged, as this may cause injury.
- Do not attempt to open the appliance. It has been ultrasonically sealed and contains no user-serviceable parts.
- This appliance can be used by persons with reduced physical, sensory or metal capabilities or lack of experience and knowledge if they have been given supervision or instruction concerning use of the appliance in a safe way and understand the hazards involved.

## SAFETY INFORMATION cont.

### Caution

- Never immerse the charging cable in water. Do not rinse it under the tap.
- Never immerse the appliance in water.
- Do not use the appliance in dishwasher/glass washer.
- Never use water hotter than 60°C to rinse the appliance.
- Only use this appliance for its intended purpose as shown in user manual.
- Never use compressed air, scouring pads, abrasive cleaning agents or aggressive liquids such as acetone to clean the appliance.
- Unit should be cleaned before and after each use with warm water.

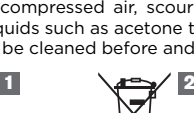
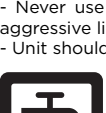

### General

- This appliance can be safely cleaned under the tap (Fig. 1).
- Clip in rear rubber cover when not in charging mode.
- Store in a safe dry area when not in use.

### Removing the rechargeable battery

This device is ultrasonically welded and sealed and cannot be opened without professional equipment. The batteries cannot be removed. It MUST be disposed of at an official collection point.

### Safety Standards

- EN 60335-1:2012+A2:2019+A14:2019
- EN 62233:2008
- EN 55014-1:2017/A11:2020
- EN 55014-2:2015
- EU 2020/1245



## CHARGING

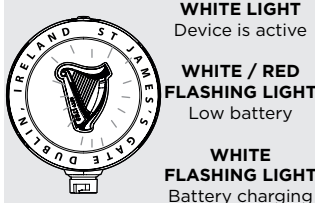
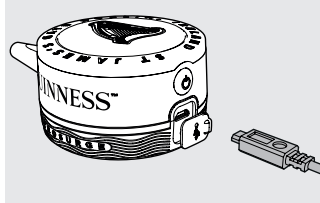

To charge, connect the Micro USB lead supplied to a USB power source. The Harp illuminates to show status as above:

Full charge takes 8 hours.

## BATTERY

- This unit contains 2 NiMH AAA rechargeable batteries.
- Voltage: DC 2 x 1.2V
- Electrical products and batteries should not be disposed of with normal household waste.
- Follow your country's rules for the separate collection of electrical products and batteries.

## SAFETY INFORMATION

### Electromagnetic Compatibility (EMC)

- This appliance complies with all applicable standards and regulations regarding emission of, and immunity to, electromagnetic fields.

## SAFETY INFORMATION cont.

### Recycling

- This symbol means that this product shall not be disposed of with normal household waste (2012/19/EU) (Fig. 2).
- This symbol means that this product contains a built-in rechargeable battery which shall not be disposed of with normal household waste (2006/66/EC) (Fig. 2).
- Follow your country's rules for the separate collection of electrical and electronic products and rechargeable batteries. Correct disposal helps prevent negative consequences for the environment and human health.

### Manufacturer and Distributor

Manufactured by Raymond Industrial Ltd, incorporated and registered in Hong Kong PRC with company number (017700220-000-10-19-9).  
Distributed by Diageo Ireland, incorporated and registered in Dublin, Ireland with company number (22876).

## WARRANTY

### Warranty and support

- If you need information or support, please visit [www.GUINNESS.com](http://www.GUINNESS.com)

The rights provided to you under this limited warranty are provided in accordance with and in addition to all rights and remedies conveyed to you by applicable consumer laws and regulations and do not restrict or affect your statutory rights. DIAGEO warrants to the buyer ("You"), that, for a period of one 1 year after you purchase (the "Term") the Guinness NitroSurge device (the "Product"), the Product shall be free from defects in materials (including the battery) and workmanship when used in accordance with the Product manual which is enclosed in the Product box at the time of purchase. Reference to DIAGEO means DIAGEO Ireland of St. James' s Gate, Dublin 8, Dublin Ireland if You are resident in the Republic of Ireland ("ROI") and DIAGEO Northern Ireland Limited, of Third Floor Capital House, 3 Upper Queen Street, Belfast, Northern Ireland if You are resident in Northern Ireland ("NI").

Any claim for breach of this warranty must be delivered in writing to Diageo Consumer Careline, St James Gate, Dublin, 8 or 3 Upper Queen Street, Belfast, BT16FB OR by email at: [gbandireland@diageo.com](mailto:gbandireland@diageo.com) within the Term. If a defect covered by this limited warranty is validated by DIAGEO and You return Your Product during the Term, DIAGEO will replace the Product with another product with the same or similar functionality to the Product You purchased. Proof of purchase is required. Such remedy shall not extend the Term. Due to technological developments, the replacement product may differ slightly to the Product that You originally purchased. Replaced products provided under this limited warranty will only be shipped to addresses within ROI and NI, where the Product is available for sale to customers. This limited warranty is only available to customers resident in ROI or NI.

## WARRANTY cont.

This limited warranty will not apply to any defect in the Product arising from fair wear and tear (including scratches), accident, misuse (including if You put the Product in the dishwasher or fully submerge the Product under water or do not close the USB rubber seal when in water or any other cleaning solutions than those recommended in the Product manual), negligence by You or any third party, alterations or repair, or use of the Product in any way that does not follow the Product manual or any other safety instructions.



**GUINNESS™**  
**DRAUGHT**  
**NITROSURGE™**  
ST JAMES'S GATE DUBLIN, IRELAND



Please scan for more information and pouring videos.